

cluster-structures

Shelter Systems

The Gregg Fleishman Studio is presenting here an inexpensive, expansive, and artful alternative to conventional building. The system features only router cut plywood panels with integral slots and notches. There are no screws, no nails, and no bolts. This makes for maximum convenience, simplified production, ease of re-use and re-configuration, minimum waste.

COMEBACK CUBE

BASICS:

The full size single cube module is made from 3/4 inch sustainable Finland Birch. It measures 9 feet by 9 feet by 9 feet, with 81 square feet of interior space and an 81 square foot rooftop deck.

FEATURES:

Roof deck access ladder
Roof deck guardrail
36 inch wide entry door
33 inch diameter side wall window openings
48 inch square rear wall window opening
7 foot by 5 foot entry landing.

OPTIONS:

Side wall extensions, 4.5 feet per panel, max. 22.5 feet total (3).
Second Floor Module, 9 feet by 9 feet, 2 ladders and spiral stair
Entry ramp access.

NOTES:

Indoor use; no special requirements.
Exterior use; permit exempt (single cube). A phenolic resin coating renders the panel surfaces waterproof. Wall edges can be oiled to allow for intermittent contact with water (such as sprinklers and drizzle) or caulked; deck joints should be caulked or treated with an elastomeric deck coating to insure impermeability. Permanent installations can be finished of like any other house, with insulation, mechanical systems, and conventional exterior treatments, like stucco. A quick and elegant temporary structure, backyard studio, guest house, or children's playroom.

Structures Parts List:

Available upon request

Assembly Instructions:

Available upon request

MATERIALS:

FINLAND, LATVIAN, or RUSSIAN EXTERIOR BIRCH PLYWOOD
Allowable stress (psi):
Extreme Fiber Stress in Bending 3,600
Compression in Plane of Panel 2,500
Rolling Shear Stress 100
Modulus of Elasticity 2,200,000
Recommended EDGE FINISH: Teak oil. SURFACE: 120 GRAM PHENOLIC FILM. Intermittent contact with water allowable.

© 2008 Gregg Fleishman

Protected by U.S. Patent #6,173,538, January 16, 2001, #6,711,860 B2, Mar. 30, 2004, #10/741,480, filed Dec. 19, 2003.

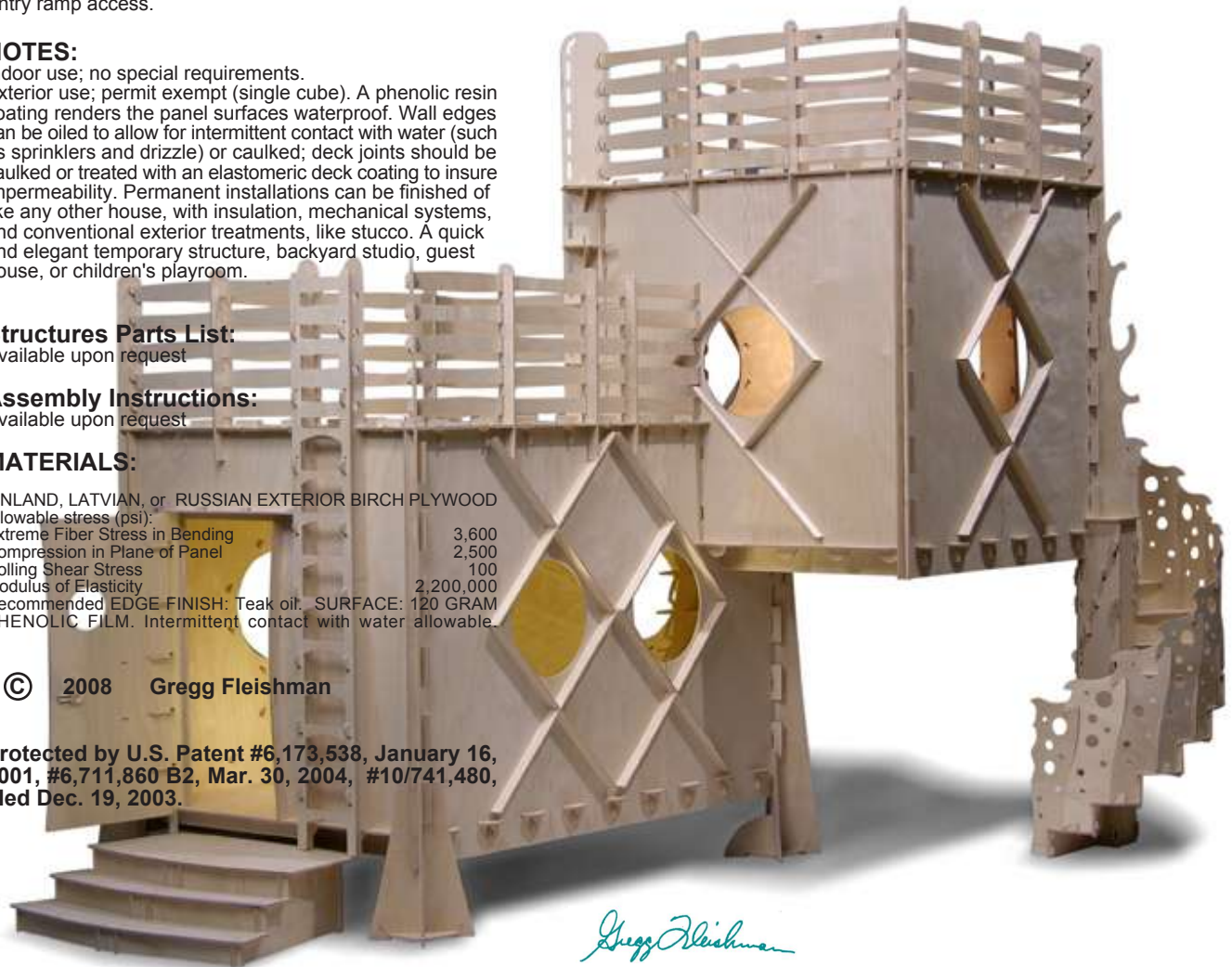
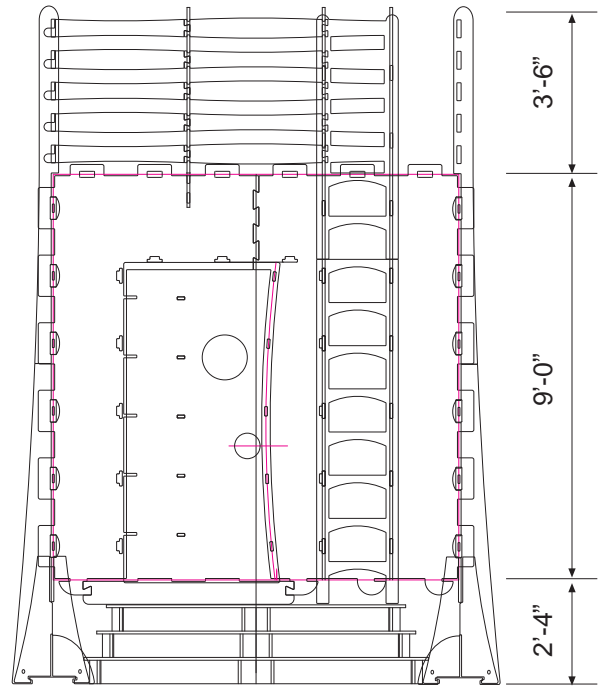

3850 MAIN STREET CULVER CITY CA
310.202.6108 WWW.GREGGFLEISHMAN.COM

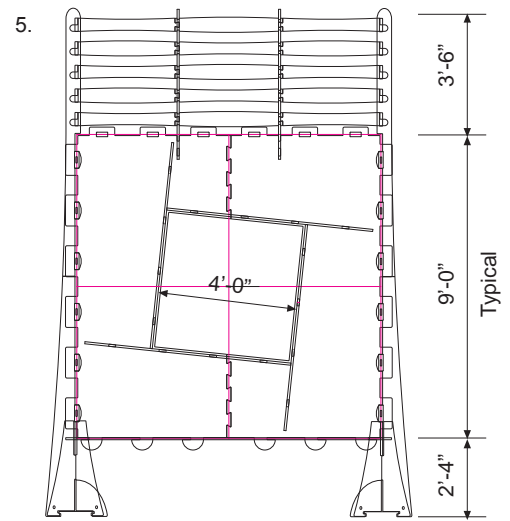
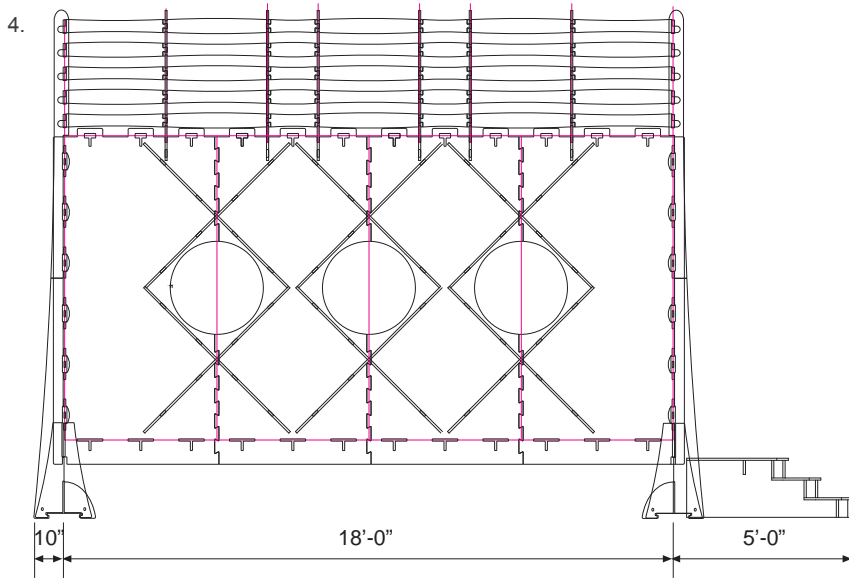

COMEBACK CUBE 2

Wall Elevations

1. Front Wall Elevation (facing page)
2. Basic Side Wall Elevation
3. 1st Extension Side Wall Elevation
4. 2nd Extension Side Wall Elevation
5. Rear Wall Elevation

