

Shelter Systems

The Gregg Fleishman Studio is presenting here a relatively inexpensive, expansive, and artful alternative to conventional building. The system features only router cut plywood panels with integral slots and notches. There are no screws, no nails, and no bolts. This makes for maximum convenience, minimum work.

SS-01

BASICS:

The geometry of the SS-01 is based on the 3D checkerboard modified to have alternately expanded and contracted cubes. This has introduced a 45 degree angled panel which is the "bevel" of the larger module and connects between the edges of the cube units. The separation allows the use of a patented three-way connection system using only the interlocking slotted plywood panels. The cubes have a structural floor while the beveled module is open to the ground or slab surface. The structure is multistory capable as the enormous capacity of the Birch Plywood will support two stories without additional members or costs.

FEATURES:

The structure is to be adapted to the requirements of each installation, factoring its location relative to climate and duration. If sprayed foam is the insulating material of choice, then thickness would be dependent on climate. Exterior membranes should be chosen relative to the time of use, stucco or metal skin for a permanent installation, and fabric or plastic sheeting for more transitory. Insulation and mechanical systems can be placed within wall thickness defined by the wall stiffeners. Other slotted plywood parts include the floor and roof joists, the spiral stair when it occurs, the door hinges and other locking members.

OPTIONS:

Entry ramp access.

NOTES:

Indoor use; no special requirements.

Exterior use; permit exempt (single cube only). For short duration installations, the phenolic resin coating renders the panel surfaces waterproof. Wall edges can be oiled to allow for contact with water (such as sprinklers and drizzle), joints should be caulked, the deck treated with an elastomeric deck coating.

Structures Parts List:

Available upon request

Assembly Instructions:

Available upon request

MATERIALS:

FINLAND, LATVIAN, or RUSSIAN EXTERIOR BIRCH PLYWOOD
 Allowable stress (psi):
 Extreme Fiber Stress in Bending 3,600
 Compression in Plane of Panel 2,500
 Rolling Shear Stress 100
 Modulus of Elasticity 2,200,000
 Recommended EDGE FINISH: Teak oil. SURFACE: 120 GRAM PHENOLIC FILM. Intermittent contact with water allowable.

© 2008 Gregg Fleishman

Protected by U.S. Patent #6,173,538, January 16, 2001, #6,711,860 B2, Mar. 30, 2004, #10/741,480, filed Dec. 19, 2003.

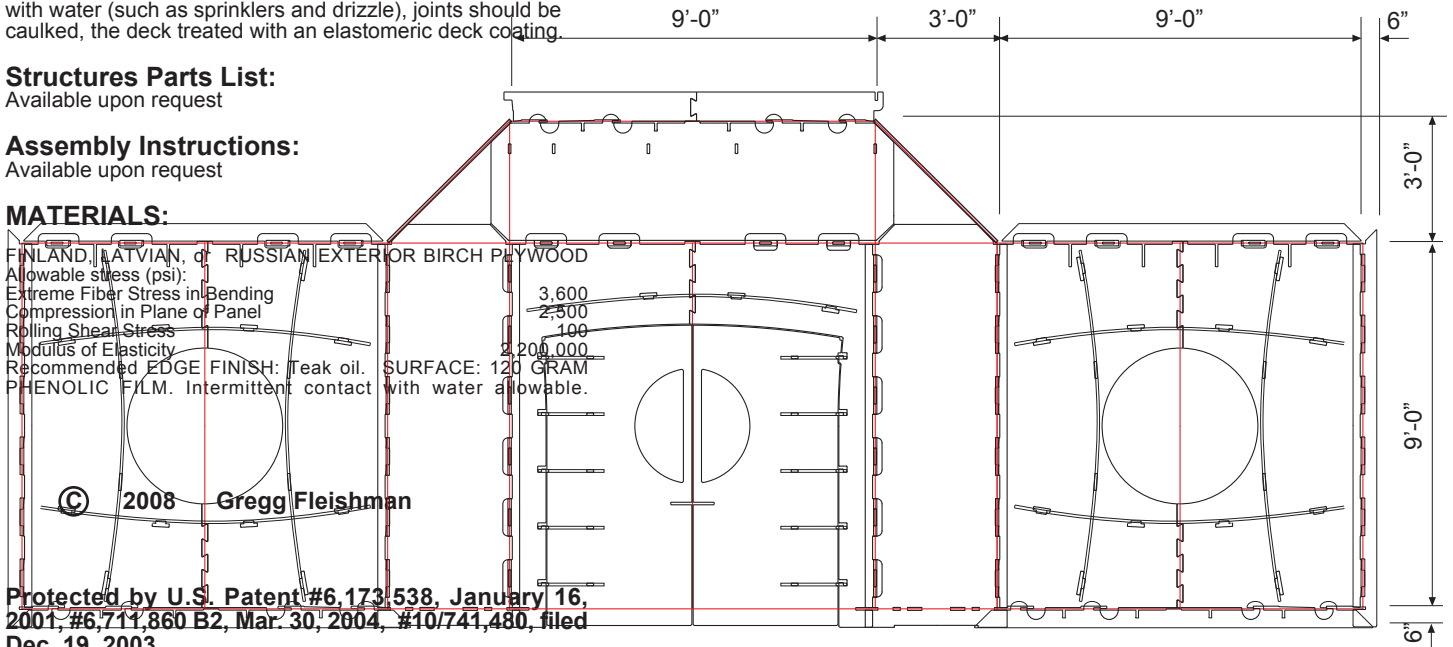
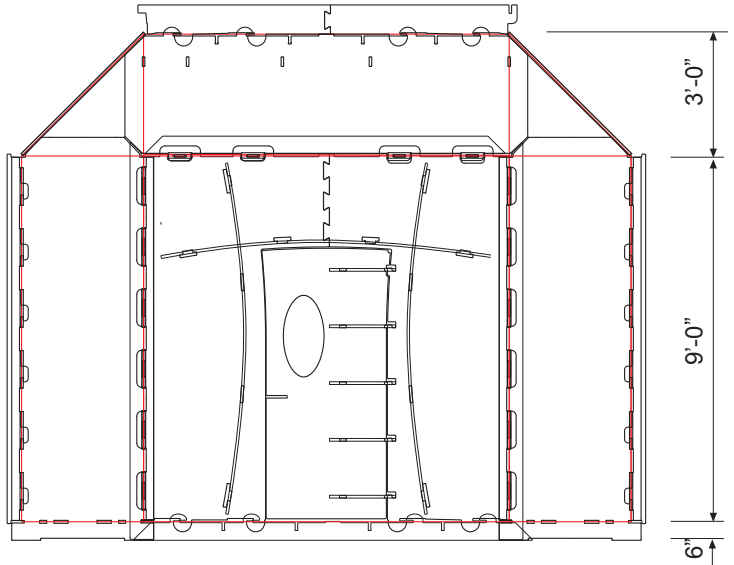

Gregg Fleishman

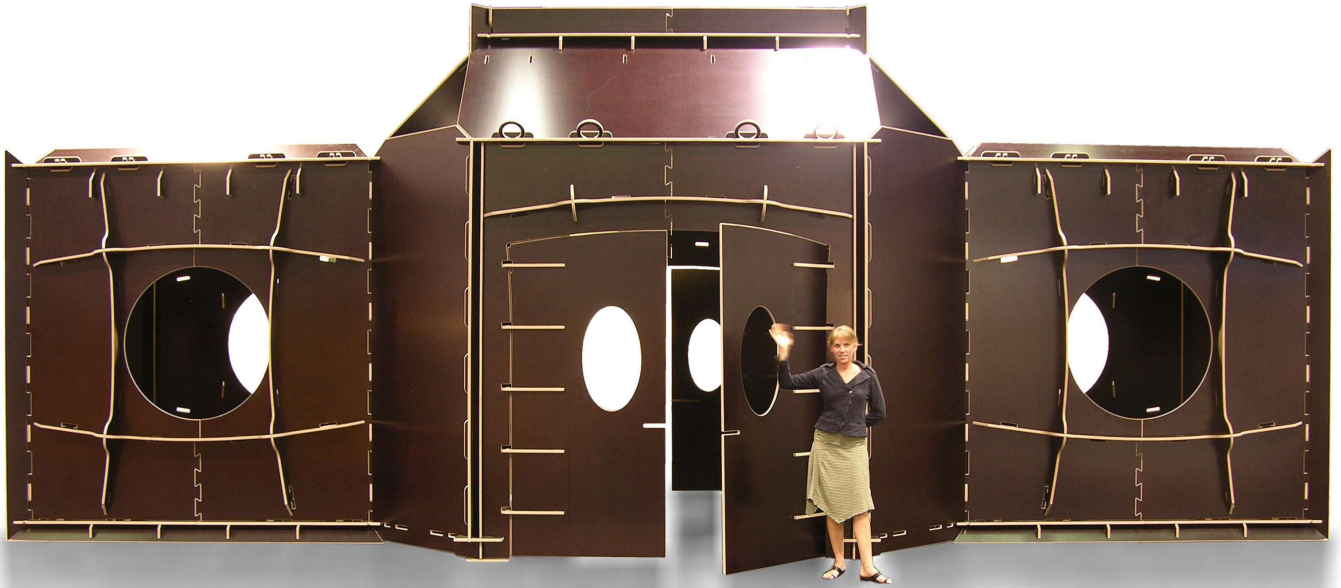

SS-01 pg. 2

SS-01 Three module group, above, 2006 installation. This was cut from 55 5' x 10' sheets of birch into 276 parts in 28 shapes. Individual cube module, right, multi-module group, including second story cube module, below.

